

August 09

STONE™

GLOBE
AIR MOTORS



ARGO
HYTOS

ATO
HYDRAULIC POWER

POWER TEAM®



Want more information?

Contact
PT Hydraulics
Head Office
or your
Regional
Sales
Manager



GLOBE geared vane air motors

The Globe Geared Vane Air Motors are of the vane type and are available with the standard range of worm and coaxial gearboxes. Producing up to 8.3 kW at 6 bar air pressure, they can generate high torque at a low speed of rotation making them suitable for a range of applications.

A compact design is achieved by directly mounting the motor to the gear box, this design also increases the motors tolerance to external environment factors. Producing exceptionally smooth operation the Globe Geared Vane Air Motors are commonly found to power mixing equipment, conveyor belts, hoists, hose reels and turntables.

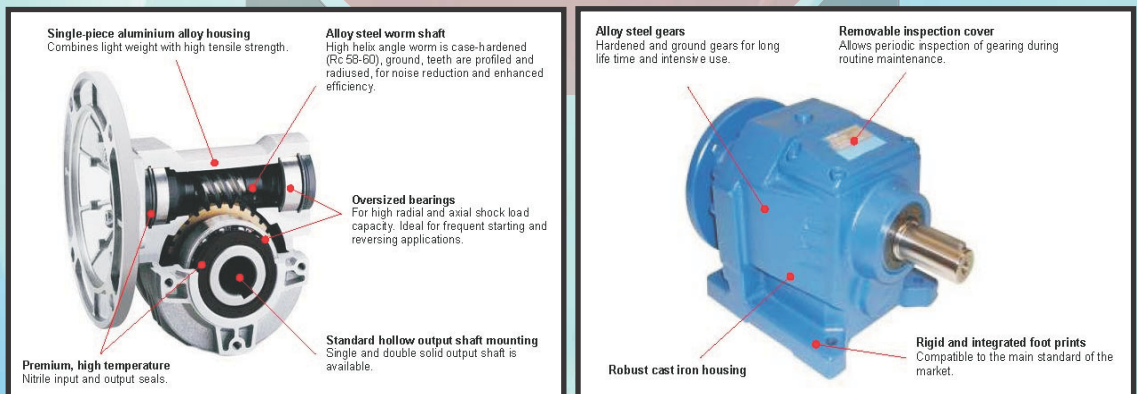

the  GLOBE AIR MOTORS B.V.

advantage

- Power up to 8.3 kW at 6 bar air pressure
- High nominal torques up to 1650Nm
- Speed of rotation as low as 7 rpm
- Easily variable & controllable speed and torque
- Perfect for applications in hazardous & aggressive environments
- No damage by overload or repeated starting
- Can be used in stall conditions
- Superior power to weight ratio
- Instantly reversible
- Minimum maintenance
- High radial & axial load permitted



handy hydraulic hint

While vibration monitoring is certainly the most widely used tool for determining rotating machinery condition, oil analysis will, in many situations, provide an earlier indication that abnormal or premature wear is in progress. Oil monitoring and analysis is especially appropriate for slow-speed machines, reciprocating machines and gearboxes, as they usually show developing faults earlier using oil versus vibration analysis. As internal machine components wear, they leave the wear particles in the lubricating oil. Identifying the existence, size, shape and elements of the wear particles leads to identifying the particular component experiencing the wear.