

FILTER - TANK IMMERSED

- DIRECT TANK MOUNTING
- PRESSURE MAX. 10 BAR / TEST 20 BAR / BURST 25 BAR
- ALL ALUMINIUM DIE CAST CONSTRUCTION
- 4 SIZES - FLOWS TO 150 LPM
- BY PASS STANDARD 1 BAR
- ELEMENTS REPLACEBLE THROUGH COVER
- SUITABLE FOR MINERAL / PETROLEUM BASED OILS
- MAX TEMP. 80 deg C

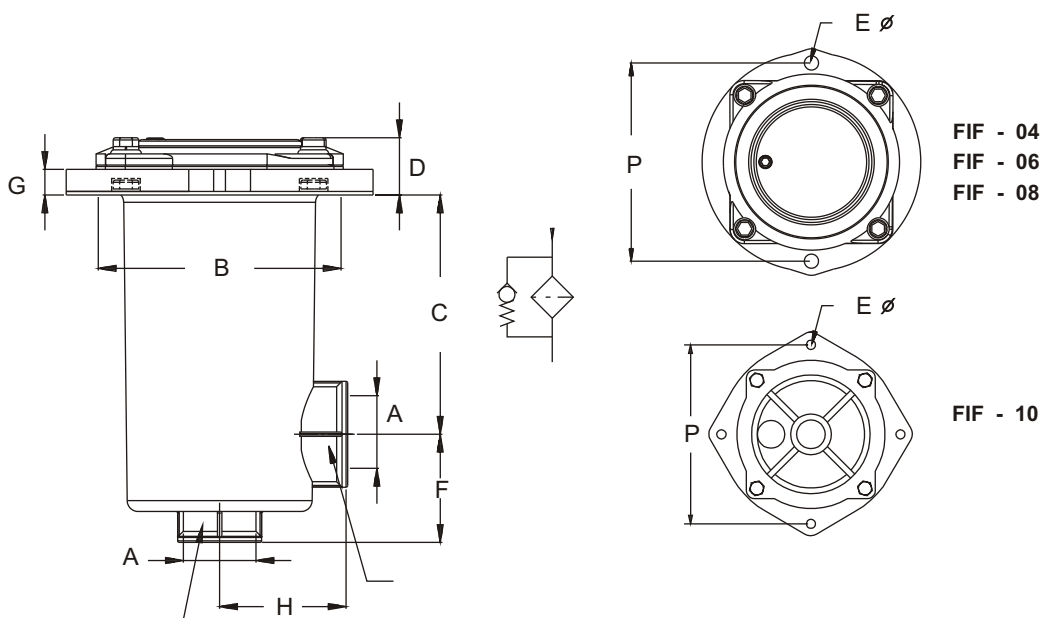

MODEL	PORT 'A' BSPP	B	C	D	E	F	G	H	P	COVER BOLT 4 OFF	WT KGS
FIF - 04	1/2 "	88	71	23	7	34	10	44	100	M 6	0.9
FIF - 06	3/4 "	110	68	24	9	52	10	58	126	M 6	1.4
FIF - 08	1 "	110	110	24	9	49	10	58	126	M 6	1.6
FIF - 10	1 - 1/4 "	156	177	48	9	62	18	83	175	M 8	3.0

FILTER - TANK IMMERSED



MODEL CODE : ASSEMBLY

F I F	- 04	B	- 010	- * *
SERIES	PORT	PORT	FILTRATION	FEATURE
	INCH	THREAD	μ MICRONS	SPECIAL #
	04 - 1/2"	B - BSPP(STD)	010 - 10 μ NOM	
	06 - 3/4"	N - NPT (OPTIONAL)	A10 - 10 μ ABS	
	08 - 1"	S - SAE	025 - 25 μ NOM	
	10 - 1-1/4"		A25 - 25 μ ABS	

MODEL CODE : ELEMENT

INDICATOR : OPTIONAL

(TO BE ORDERED SEPERATELY)

GR 40 - VISUAL INDICATOR

E R - ELECTRICAL INDICATOR

F I E	- 04	- 010
SERIES	SIZE	FILTRATION
		μ MICRONS
F I E	04	010 - 10 μ NOM
	06	A10 - 10 μ ABS
	08	025 - 25 μ NOM
	10	A25 - 25 μ ABS

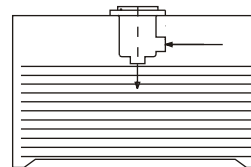

F I F

OIL VISCOCITY 32 cSt @ 30° C

(A) - 10 MICRONS (B) - 25 MICRONS

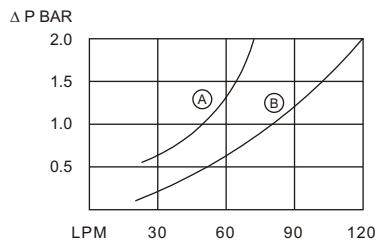

FIF - 06
FIF - 04 - FLOW 20 LPM

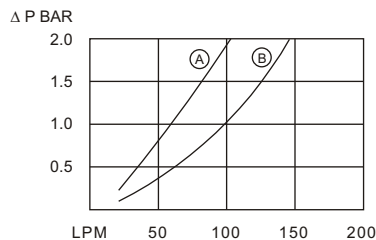

FIF - 08

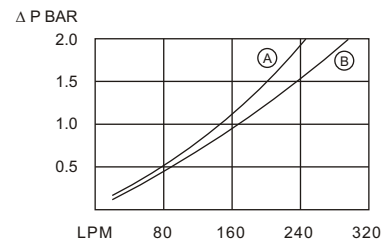

FIF - 10

OPTIONAL / SPECIAL FEATURE - OMIT IF NOT REQUIRED

FILTER - TANK IMMERSED

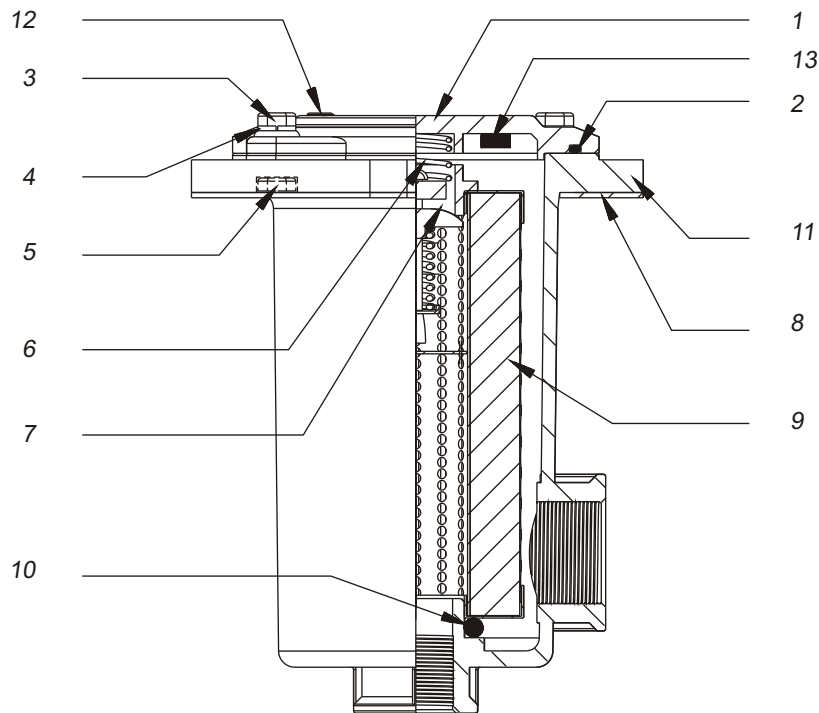

Item No	Part Name	Qty	FIF - 04	FIF- 06	FIF - 08	FIF - 10
1	Cover	1				
2	Cover O Ring	1	68.0x2.9	95.0X3.5	95.0X3.5	135.0 X3.0
3	Bolt	4	M6 x 23	M6 x 23	M6 x 23	M8x25
4	Spring Washer	4	M6	M6	M6	M8
5	Nut	4	M6 x 1	M6 x1	M6 x 1	M8x1.25
6	Element Spring	1				
7	By Pass Valve Assembly	1	Built in			
8	Body-Tank Gasket	1				
9	Element(Refer Model Code)	1				
10	Body-Element O Ring	1	24.0 x 2.5	29.5 x 4.8	29.5 x 4.8	39.0 x 4.0
11	Body(Refer Model Code)	1				
12	Grub Screw 1/8" NPT	1				
13	Magnet	1				

O Ring Size - Internal Dia mm x Cross Sectional Dia mm

FILTER - TANK IMMERSED

- DIRECT TANK MOUNTING
- PRESSURE - MAX. 7 BAR / TEST 12 BAR / BURST 16 BAR
- ALUMINIUM DIECAST BODY HOUSING / POLYAMIDE G.F. BOWL
- 4 - SIZES FLOWS TO 175 LPM
- BY PASS STANDARD 1 BAR
- ELEMENTS REPLACEBLE THROUGH COVER
- SUITABLE FOR MINERAL / PETROLEUM BASED OILS
- MAX. TEMP 80°C

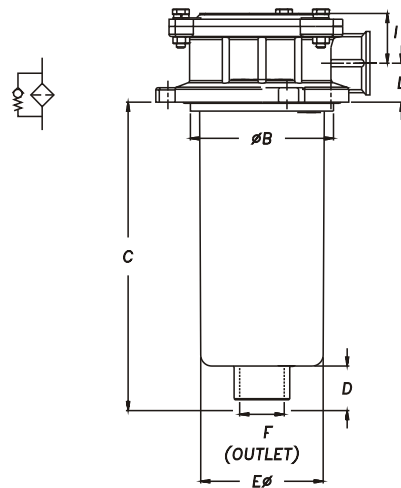
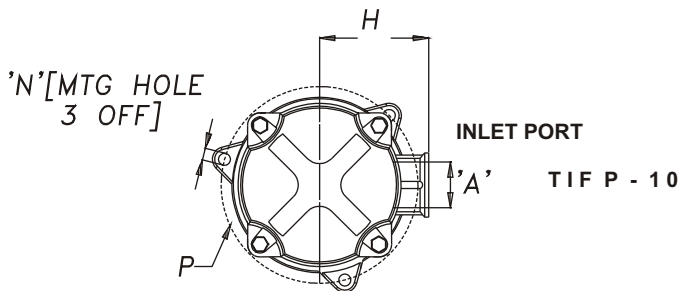
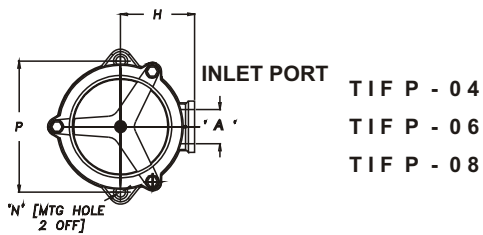

MODEL	PORT 'A' BSPP	B	C	D	E	PORT 'F' Dia	H	I	L	N	P	ELEMENT AREA SQ CMS 10 / 25 m	WT KGS
TIFP - 04	1 / 2"	69	89	15	58	19	53	25	22	6.6	90	710	-
TIFP- 06	3 / 4"	87	100	25	78	22	65	36	28	8.5	115	1225	-
TIFP - 08	1"	87	151	25	80	22	65	36	28	8.5	115	2450	-
TIFP- 10	1 - 1 / 4"	129	278	40	110	39	97	45	35	10.5	175	6120	-

FILTER - TANK IMMERSED



OIL VISCOCITY 32 cSt @ 30° C

(A) - 10 MICRONS (B) - 25 MICRONS

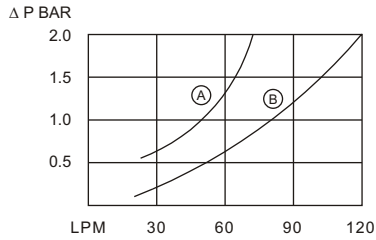

TIFP - 06

TIFP - 04 - FLOW 20 LPM

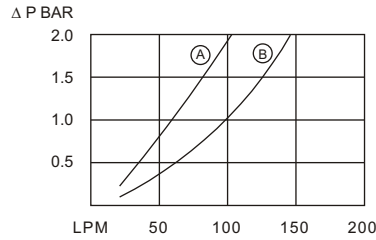

TIFP - 08

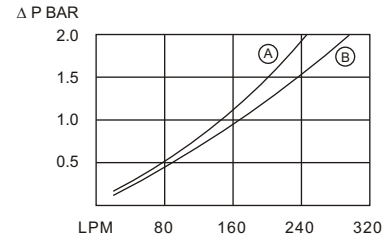

TIFP - 10

MODEL CODE : ASSEMBLY

TIF P	- 08 B	- 010	- *
SERIES	PORT 'A' THREAD	FILTRATION μ MICRONS	FEATURE SPECIAL #
P - CAST BODY/PLASTIC BOWL	04 - 1/2"	B - BSPP	010 - 10 μ NOM
	06 - 3/4"		A10 - 10 μ ABS
	08 - 1"	N - NPT	025 - 25 μ NOM
	10 - 1 - 1/4"		A25 - 25 μ ABS

MODEL CODE : ELEMENT

TIE	- 08	- 010
SERIES	SIZE	FILTRATION μ MICRON
TIE	04	010 - 10 μ NOM
	06	A10 - 10 μ ABS
	08	025 - 25 μ NOM
	10	A25 - 25 μ ABS

INDICATOR : OPTIONAL

(TO BE ORDERED SEPERATELY)

GR 40 - VISUAL INDICATOR

ER - ELECTRICAL INDICATOR

OPTIONAL / SPECIAL FEATURE - OMIT IF NOT REQUIRED
CONSULT FACTORY FOR β₂₅ = 75 (ABSOLUTE) RATED ELEMENTS AVAILABILITY

FILTER - TANK IMMERSED

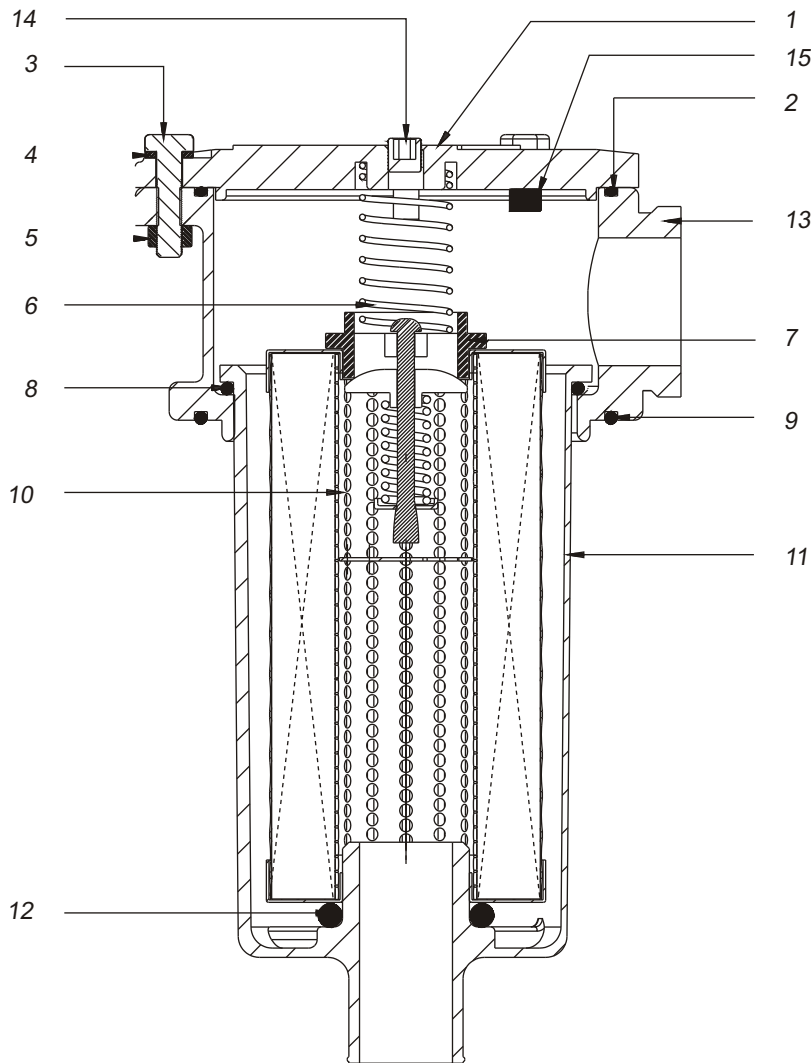

Item No	Part Name	Qty	TIFP - 04	TIFP - 06	TIFP - 08	TIFP - 10
1	Cover	1				
2	Cover O Ring	1	70.5x2.0	93.0x2.7	93.0x2.7	127.0 x 3.8
3	Bolt	3	M6 x 25	M6 x 25	M6 x 25	M8x30 (4off)
4	Spring Washer	3	M6	M6	M6	M8 (4off)
5	Nut	3	M6 x 1	M6 x1	M6 x 1	M8x1.25(4off)
6	Element Spring	1				
7	By Pass Valve Assembly	1	Built in			
8	Bowl-Body O Ring	1	59.0 x 3.0	75.0 x 3.0	75.0 x 3.0	109.5 x 4.3
9	Body-Tank O Ring	1	67.5 x 2.7	93.5 x 2.7	93.5 x 2.7	128.5 x 6.3
10	Element(Refer Model Code)	1				
11	Bowl	1				
12	Bowl-Element O Ring	1	23.75 x 2.65	29.5 x 4.8	29.5 x 4.8	39.0 x 4.0
13	Body(Refer Model Code)	1				
14	Grub Screw 1/8" NPT	1				
15	Magnet	1				

O Ring Size - Internal Dia mm x Cross Sectional Dia mm

FILTER - TANK IMMERSED

- DIRECT TANK MOUNTING
- PRESSURE - MAX. 10 BAR / TEST 20 BAR / BURST 25 BAR
- ALL ALUMINIUM DIECAST CONSTRUCTION
- 4 - SIZES FLOWS TO 175 LPM
- BY PASS STANDARD 1 BAR
- ELEMENTS REPLACEBLE THROUGH COVER
- SUITABLE FOR MINERAL / PETROLEUM BASED OILS
- MAX TEMP. 80 deg C

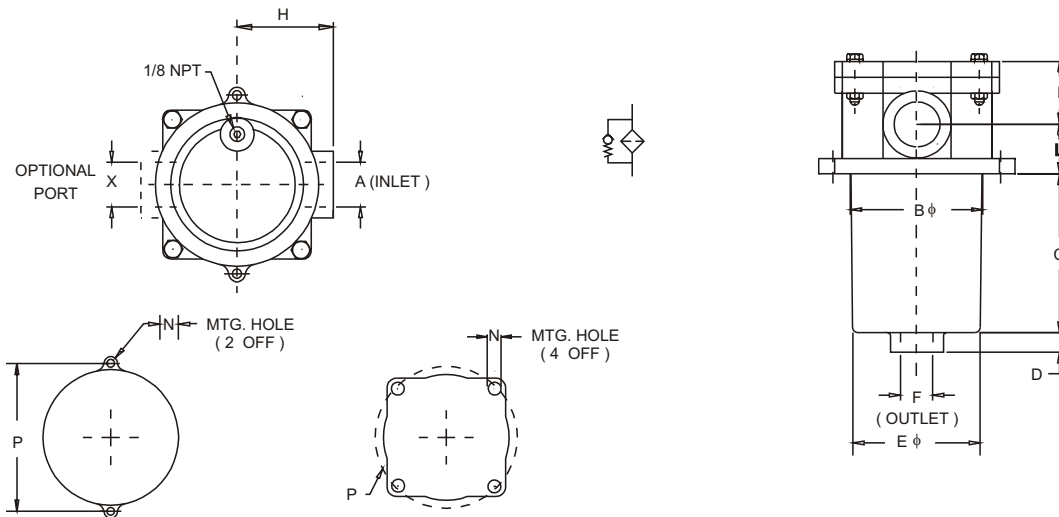

TIF 2 - 0 4
TIF 2 - 0 6
TIF 2 - 0 8

TIF 2 - 10

MODEL	PORT 'A' BSPP	PORT 'X' BSPP	B	C	D	E	PORT 'F' BSPP	H	I	L	N	P	ELEMENT AREA SQ CMS 10 / 25 m	WT KGS
TIF2 - 04	1 / 2"	-	65	65	13	62	1 / 2"	51	28	22	6.6	90	710	0.9
TIF2 - 06	3 / 4"	-	89	65	13	84	3 / 4"	70	32	26	8.2	114	1225	1.5
TIF2 - 08	1"	-	89	108	13	84	3 / 4"	70	36	26	8.2	114	2450	1.7
TIF2 - 06 / 08	1"	3 / 4"	89	108	13	84	3 / 4"	70	36	26	8.2	114	2450	1.8
TIF2 - 10	1 - 1 / 4"	1 - 1 / 4"	129	213	19	122	1 - 1 / 4"	178	56	44	10.5	175	6120	4.0

FILTER - TANK IMMERSED



OIL VISCOCITY 32 cSt @ 30° C

(A) - 10 MICRONS (B) - 25 MICRONS

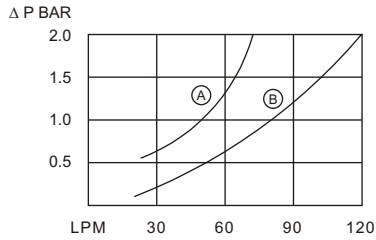

TIF2 - 06
TIF2 - 04 - FLOW 20 LPM

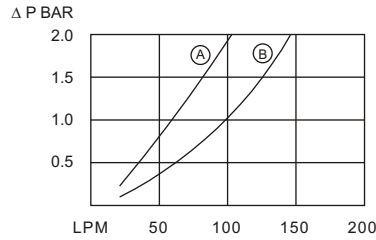

TIF2 - 08

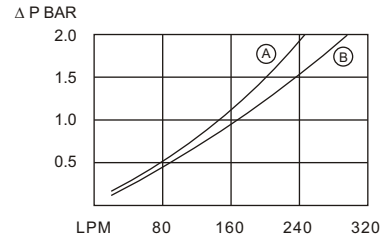

TIF2 - 10

MODEL CODE : ASSEMBLY

TIF 2	- 08	- **	B	- 010	- *
SERIES	PORT 'A' INCH (BSPP)	PORT 'X' OPTIONAL # INCH (BSPP)	PORT THREAD	FILTRATION μ MICRONS	FEATURE SPECIAL #
2 - ALL CAST	04 - 1/2"		B - BSPP	010 - 10 μ NOM	
	06 - 3/4"			A10 - 10 μ ABS	
	08 - 1"	06 - 3/4"	N - NPT	025 - 25 μ NOM	
	10 - 1 - 1/4"	10 - 1 - 1/4"		A25 - 25 μ ABS	

MODEL CODE : ELEMENT

TIE	- 08	- 010
SERIES	SIZE	FILTRATION μ MICRON
TIE	04	010 - 10 μ NOM
	06	A10 - 10 μ ABS
	08	025 - 25 μ NOM
	10	A25 - 25 μ ABS

INDICATOR : OPTIONAL

(TO BE ORDERED SEPERATELY)

GR 40 - VISUAL INDICATOR

ER - ELECTRICAL INDICATOR

OPTIONAL / SPECIAL FEATURE - OMIT IF NOT REQUIRED

FILTER - TANK IMMERSED

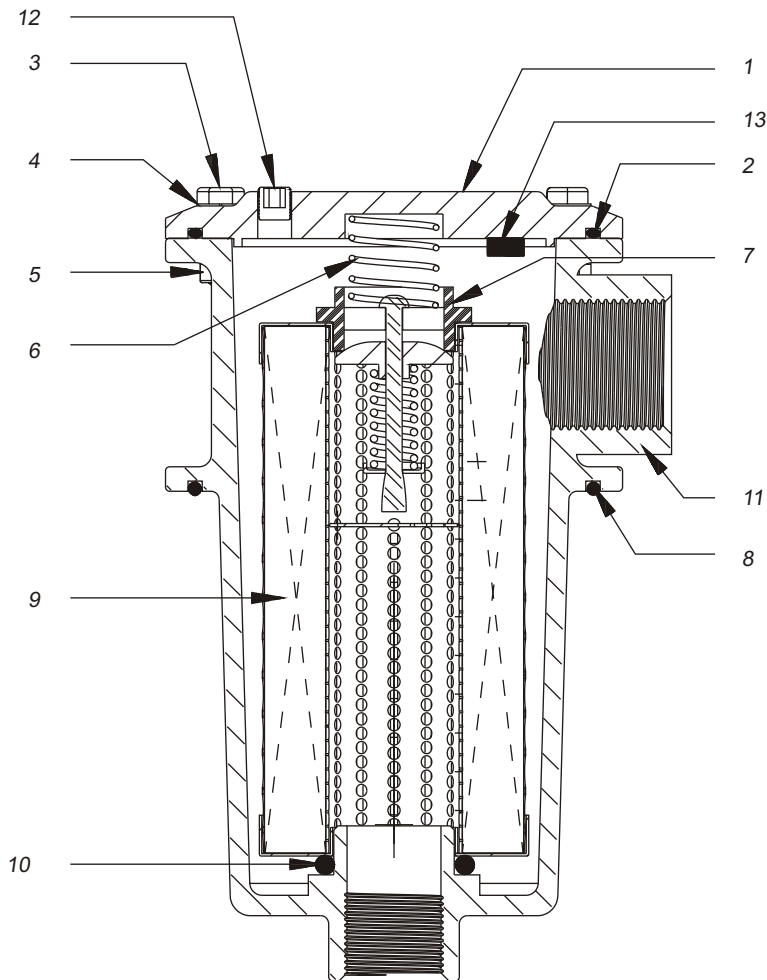

Item No	Part Name	Qty	TIF2 - 04	TIF2- 06	TIF2 - 08	TIF2 - 10
1	Cover	1				
2	Cover O Ring	1	68.0x2.9	95.0X3.5	95.0X3.5	135.0 X3.0
3	Bolt	4	M6 x 20	M6 x 20	M6 x 20	M8x35
4	Spring Washer	4	M6	M6	M6	M8
5	Nut	4	M6 x 1	M6 x1	M6 x 1	M8x1.25
6	Element Spring	1				
7	By Pass Valve Assembly	1	Built in			
8	Body-Tank O Ring	1	72.5 x 3.0	95X3.5	95X3.5	134X4.5
9	Element(Refer Model Code)	1				
10	Body-Element O Ring	1	24.0 x 2.5	29.5 x 4.8	29.5 x 4.8	39.0 x 4.0
11	Body(Refer Model Code)	1				
12	Grub Screw 1/8" NPT	1				
13	Magnet	1				

O Ring Size - Internal Dia mm x Cross Sectional Dia mm

FILTER - TANK / LINE MOUNTED

- DIRECT TANK OR LINE MOUNT
- 5 SIZES - FLOWS TO 700 LPM
- BY PASS STANDARD 1 BAR RETURN / 0.35 BAR SUCTION
- ALUMINIUM DIECAST CONSTRUCTION
- WORKING PRESSURE TO 20 BAR / TEST 30 BAR / BURST 40 BAR
- CAN BE USED FOR RETURN / SUCTION LINES
- MAX TEMP. TO 80° C
- SUITABLE FOR MINERAL / PETROLEUM BASED OILS

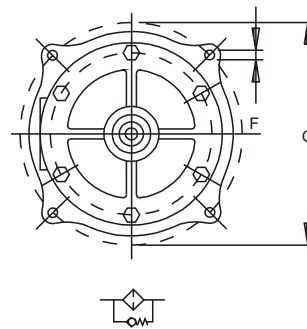
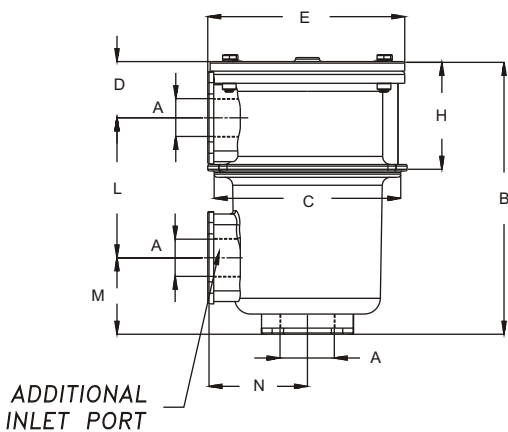

MODEL	PORT 'A' BSPP	B	C	D	E	F	G	H	L	M	N	ELEMENT AREA (SQ CMS)		WT KGS
												10 / 25 PAPER	149 SS MESH	
CFR* - 025	1/2"	117	84	29	99	5.6	95	47	55	31.5	52	645	180	1.36
CFR* - 040	3/4"	172	121	41	119	6.5	138	77	105	26	59	1750	500	2.27
CFR* - 100	1"	241	135	51	134	6.5	154	100	140	50	67	2650	900	2.95
CFR* - 250	1 - 1/2"	295	162	63	176	8.5	180	112	159	73	93	7900	2080	5.45
CFR* - 630	2 - 1/2" SAE	342	234	72	242	10.5	275	140	174	95	122	14500	3500	11.8

FILTER - TANK / LINE MOUNTED



MODEL CODE : ASSEMBLY

CFR	2	- 0 2 5	- 04	B	- 0 1 0	- *
SERIES	SIZE	PORT	CONNECTION	FILTRATION	FEATURE	SPECIAL #
		INCH		μ MICRONS		
R - RETURN	0 2 5	04 - 1/2"	B - BSPP (STD)	010 - 10 μ NOM	SAE FLANGE S1 - METRIC BOLTS (STD) S2 - UNC BOLTS	
S - SUCTION	0 4 0	06 - 3/4"	N - NPT	A10 - 10 μ ABS		
2 - ADDL INLET PORT (OPTIONAL#)	1 0 0	08 - 1"	S - SAE (FLANGE 100 / 250 only)	025 - 25 μ NOM		
	2 5 0	12 - 1-1/2"		A25 - 25 μ ABS		
	6 3 0	20 - 2-1/2"	S - SAE (FLANGE)	149 - 149 μ NOM		
				74 - 74 μ NOM		

MODEL CODE : ELEMENT

CE	- 0 2 5	- 0 1 0
SERIES	SIZE	FILTRATION
		μ MICRONS
CE	0 2 5	010 - 10 μ NOM
	0 4 0	A10 - 10 μ ABS
	1 0 0	025 - 25 μ NOM
	2 5 0	A25 - 25 μ ABS
	6 3 0	149 - 149 μ NOM
		74 - 74 μ NOM

INDICATOR : OPTIONAL (TO BE ORDERED SEPERATELY)

GR - VISUAL RETURN
GS - VISUAL SUCTION

ER - ELEC. RETURN
ES - ELEC. SUCTION

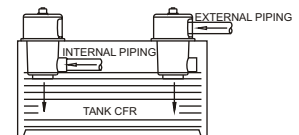
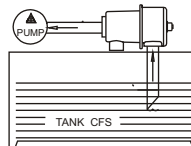
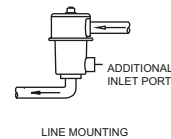

OIL VISCOCITY 32 cSt @ 30° C

(A) - 10 MICRONS (B) - 25 MICRONS (C) - 149 MICRONS

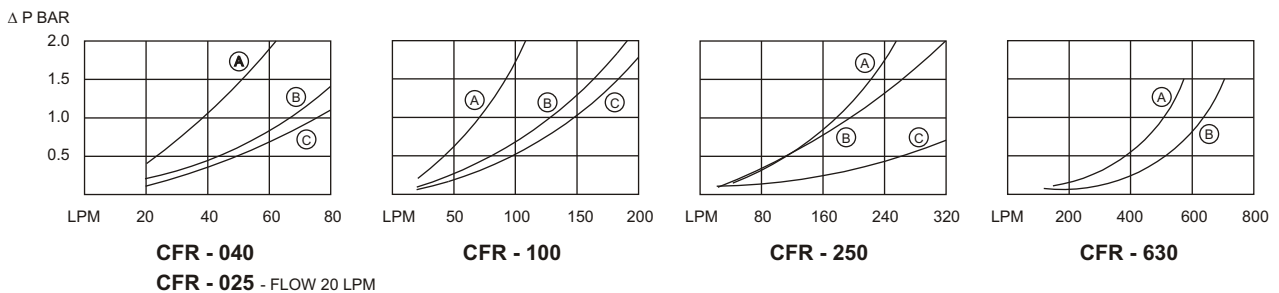

OPTIONAL / SPECIAL FEATURE - OMIT IF NOT REQUIRED

FILTER - TANK / LINE MOUNTED

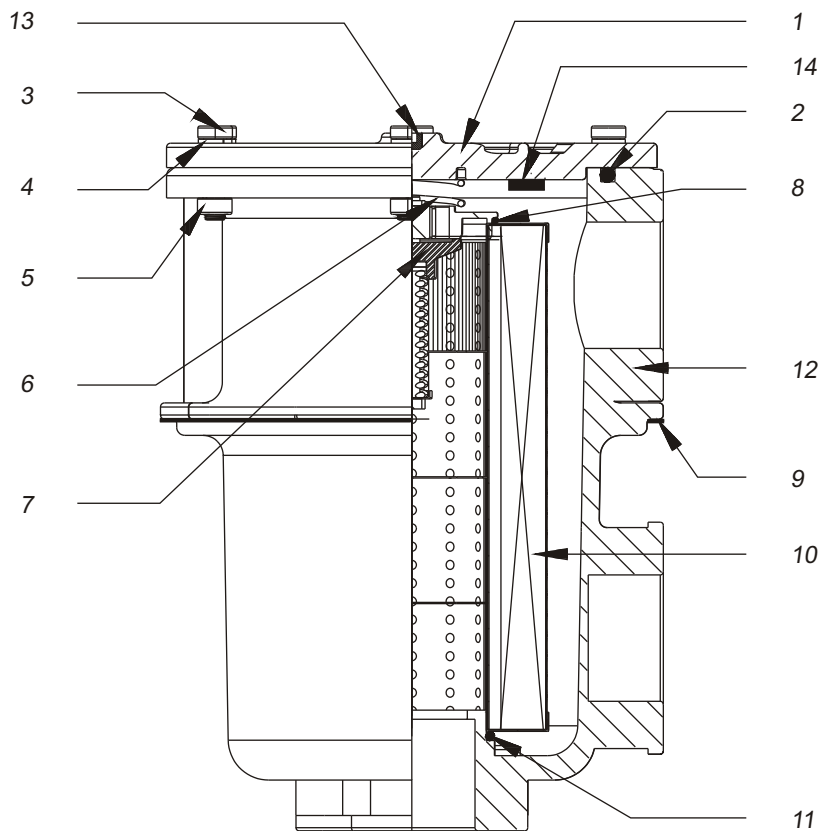

Item No	Part Name	Qty	CFR - 025	CFR - 040	CFR - 100	CFR - 250	CFR-630
1	Cover	1					
2	Body O Ring	1	63.2 X 1.8	88.5 X 3.5	96.5 X 3.5	121.0X 3.0	187 X 6.5
3	Bolt	4	M5 x 20	M6 x 35	M8 X 35	M10 X 45	M10 X 45
4	Spring Washer	4	M5	M6	M8	M10	M10
5	Nut	4	M5 X 0.8	M6 x1	M8 X 1.25	M10 X 1.5	M10 X 1.5
6	Element Spring	1					
7	By Pass Valve Assembly	1	Built in				
8	By Pass Valve O Ring			30.0 X 5.0	30.0 X 5.0		74.0 X 3.0
9	Body-Tank Gasket	1					
10	Element(Refer Model Code)	1					
11	Body-Element O Ring	1	25.0 x 2.6	34.5 x 3.5	34.5 X 3.5		74.0 X 3.0
12	Body(Refer Model Code)	1					
13	Grub Screw 1/8" NPT	1					
14	Magnet	1					

O Ring Size - Internal Dia mm x Cross Sectional Dia mm

FILTER - TANK IMMERSED

- DIRECT TANK MOUNTING
- PRESSURE - MAX. 7 BAR / TEST 12 BAR / BURST 16 BAR
- ALUMINIUM / PLASTIC CONSTRUCTION
- 3 SIZES FLOW TO 150 LPM
- BY PASS STANDARD 1 BAR
- SUITABLE FOR MINERAL / PETROLEUM BASED OILS
- MAX. TEMP

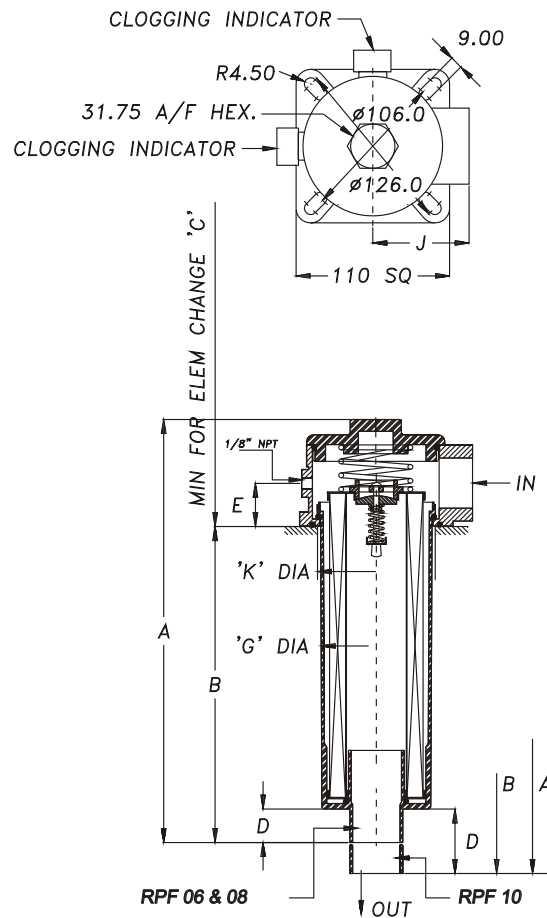

MODEL NO	THDS	A	B	C	D	E	G	H	J	K
RPF - 06	3/4" BSPP	307.00	230.00	350.00	24.00	30.00	80.00	38.00	66.00	80.00 ^{+2.8}
RPF - 08	1" BSPP	307.00	230.00	350.00	24.00	30.00	80.00	38.00	66.00	80.00 ^{+2.8}
RPF - 10	1- 1/4" BSPP	390.00	311.00	405.00	24.00	30.00	80.00	38.00	66.00	80.00 ^{+2.8}

FILTER - TANK IMMERSED



MODEL CODE : ASSEMBLY

RPF	- 16S	B	L1	- 10
SERIES	PORT SIZE	PORT CONNECTION	BOWL LENGTH	FILTRATION m MICRONS
	06 - 3/4"	B - BSPP N - NPT	L1-220	10 - 10 m NOM
	08 - 1"			A10 - 10 m ABS
	10 - 1-1/4"	S - SAE	L2-300	25 - 25 m NOM A25 - 25 m ABS

CONSULT FACTORY
FOR OPTIONAL
SAE THREADS

16S / 20S / 24S

MODEL CODE : ELEMENT

RPE	- L1	- 10
SERIES	ELEMENT SIZE	FILTRATION m MICRONS
	L1 - 120 - LPM	10 - 10 m NOM
		A10 - 10 m ABS
	L2 - 150 LPM	25 - 25 m NOM
		A25 - 25 m ABS

OPTIONAL / SPECIAL FEATURE - OMIT IF NOT REQUIRED
COMPLETE RANGE UNDER DEVELOPMENT
CONTACT FACTORY FOR PERFORMANCE DETAILS

FILTER - TANK IMMERSED

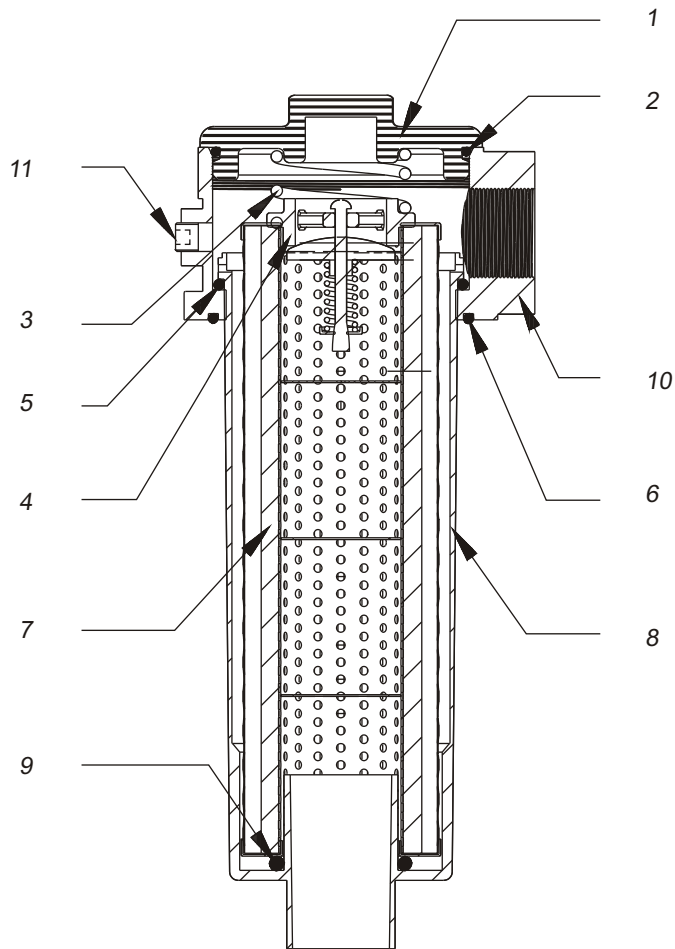

Item No	Part Name	Qty	RPF - 06	RPF - 08	RPF - 10
1	Cover	1			
2	Cover O Ring	1	95.0 X 3.5	95.0 X 3.5	95.0 X 3.5
3	Element Spring	1			
4	By Pass Valve Assembly	1			
5	Bowl-Body O Ring	1	75.0 x 3.0	75.0 x 3.0	75.0 x 3.0
6	Body-Tank O Ring	1	85.0 x 2.6	85.0 X 2.6	85.0 X 2.6
7	Element(Refer Model Code)	1			
8	Bowl(Refer Model Code)	1			
9	Bowl-Element O Ring	1	39.5 X 4.0	39.5 x 4.0	39.5 x 4.0
10	Body(Refer Model Code)	1			
11	Grub Screw 1/8" NPT	1			

O Ring Size - Internal Dia mm x Cross Sectional Dia mm