

KG11

CONTROL HANDSET FOR SINGLE-ACTING UNITS

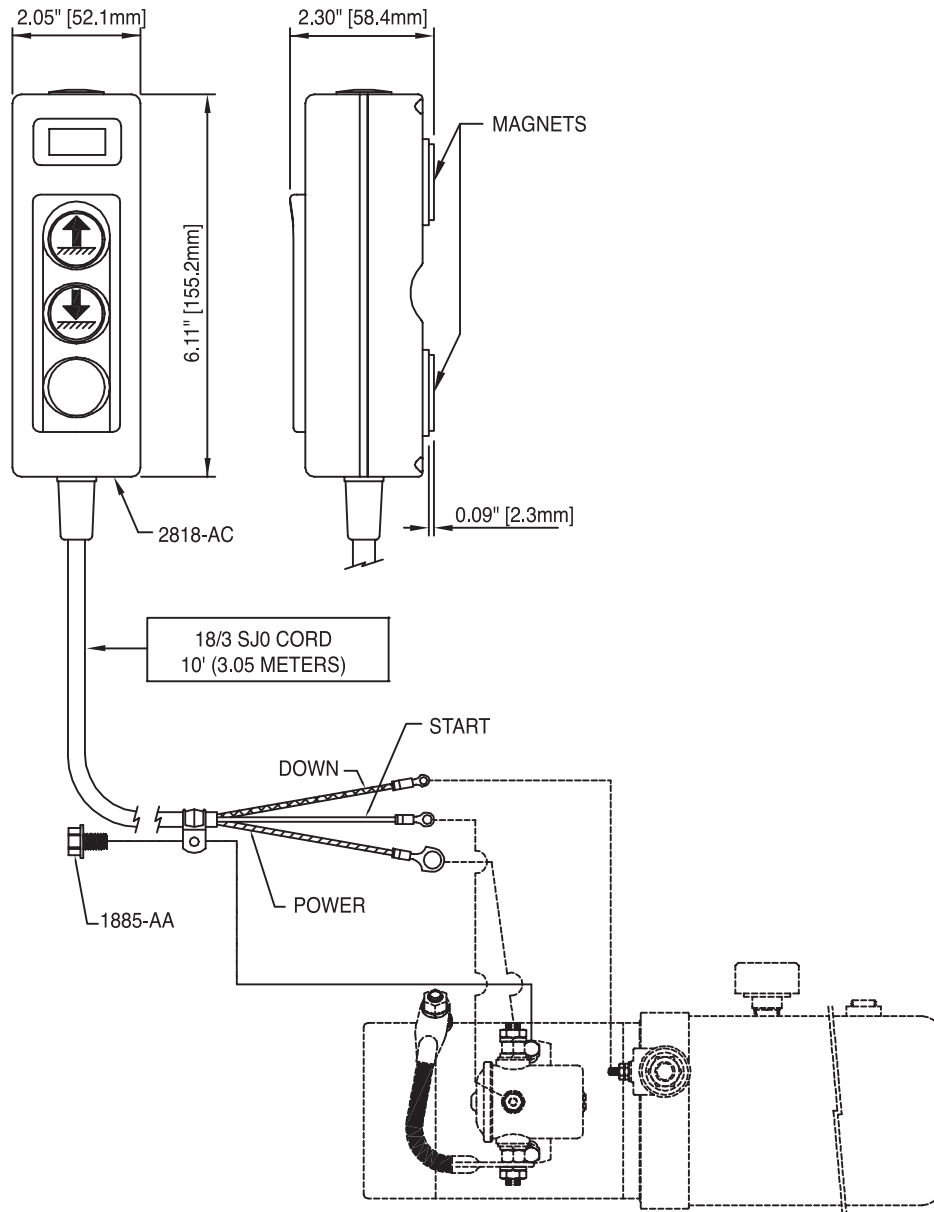

DC voltage only.

To be used with DC-20SF power units and KS_ and KC01C or KC01F valve kit.

For bulkhead mounting, order holster 2817-AA.

For wall mounting, order bracket hook 2686-AA.

Magnets are intended for convenience during use. They are not intended to support the handset during motion.

WIRE COLOR CODE		
EUROPE	UNITED STATES	FUNCTION
BROWN	GREEN	POWER
BLUE	WHITE	START
GREEN/YELLOW	BLACK	DOWN

CONTROL HANDSET FOR SINGLE-ACTING UNITS FOR SMART START

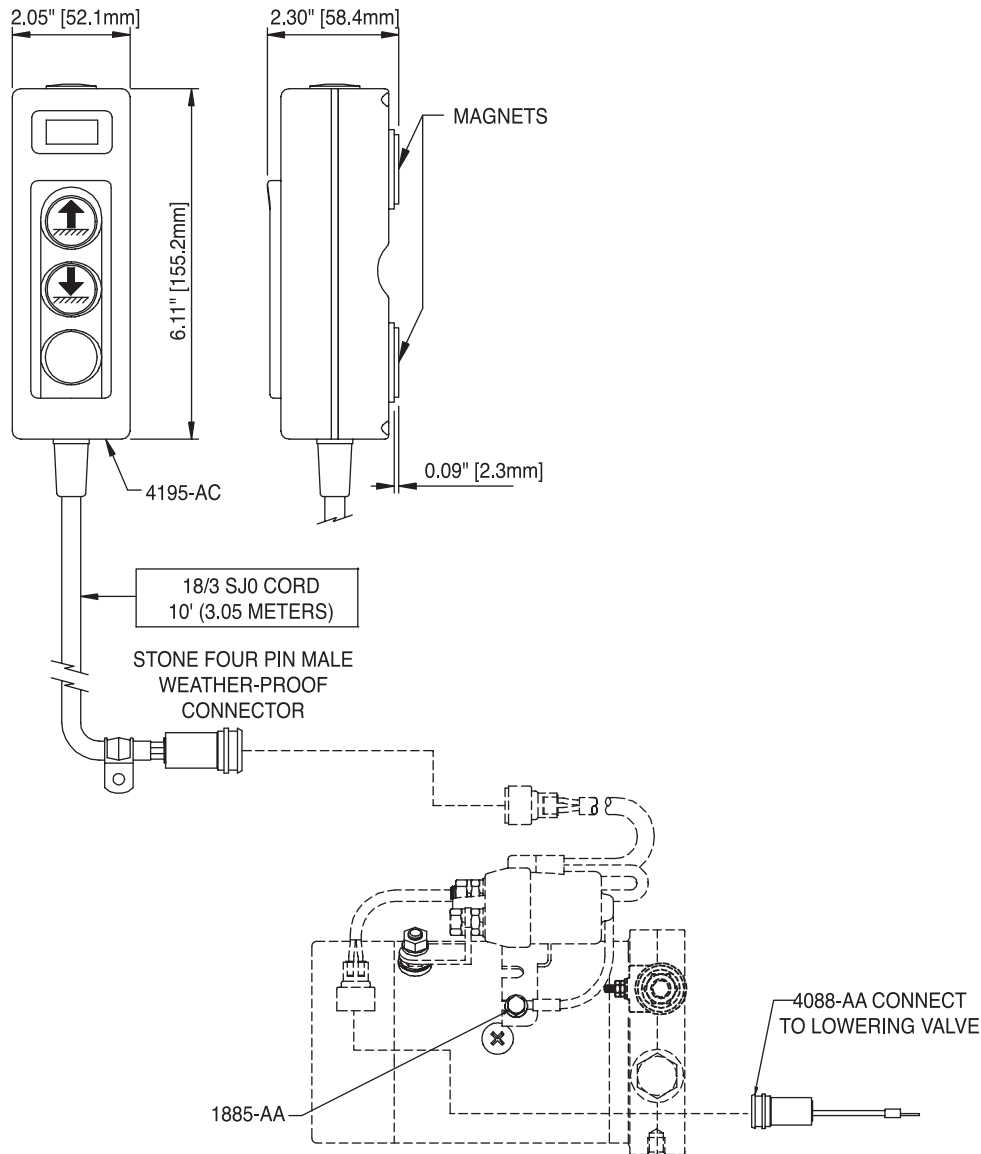

DC voltage only.

To be used with DC-20SF power units and KC01C or KC01F valve kit, using KS5 start solenoid.

For bulkhead mounting, order holster 2817-AA.

For wall mounting, order bracket hook 2686-AA.

Magnets are intended for convenience during use. They are not intended to support the handset during motion.

Use 3467-AA jumper when using 24 volts.

Order 3553-AA when wiring smart start to other than Stone supplied cordset.

KG12

CONTROL HANDSET FOR DOUBLE-ACTING UNITS

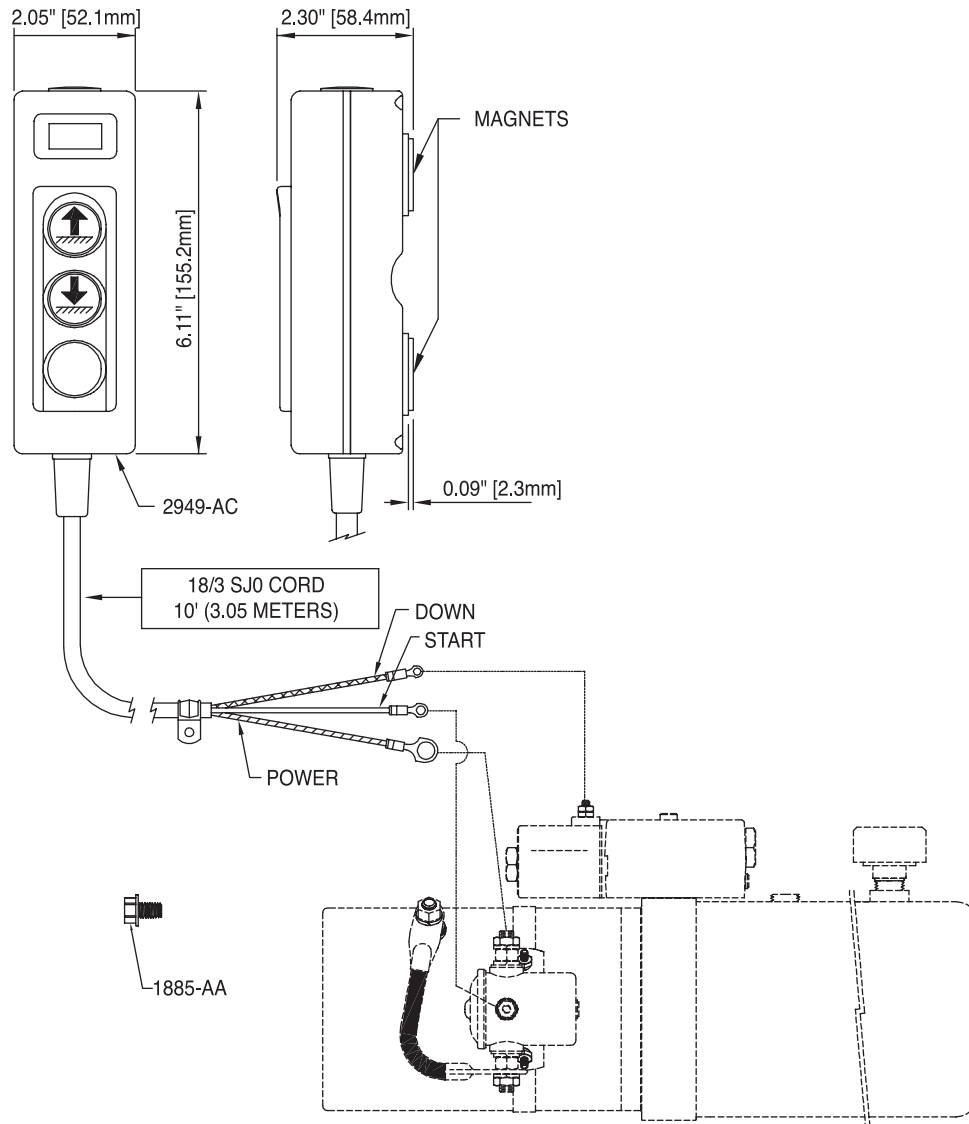

DC voltage only.

To be used with DC-70SF, DC-70BS power units and SK_start solenoid.

For bulkhead mounting, order holster 2817-AA.

For wall mounting, order bracket hook 2686-AA.

Magnets are intended for convenience during use. They are not intended to support the handset during motion.

WIRE COLOR CODE		
EUROPE	UNITED STATES	FUNCTION
BROWN	GREEN	POWER
BLUE	WHITE	START
GREEN/YELLOW	BLACK	DOWN

CONTROL HANDSET FOR DOUBLE-ACTING UNITS FOR SMART START

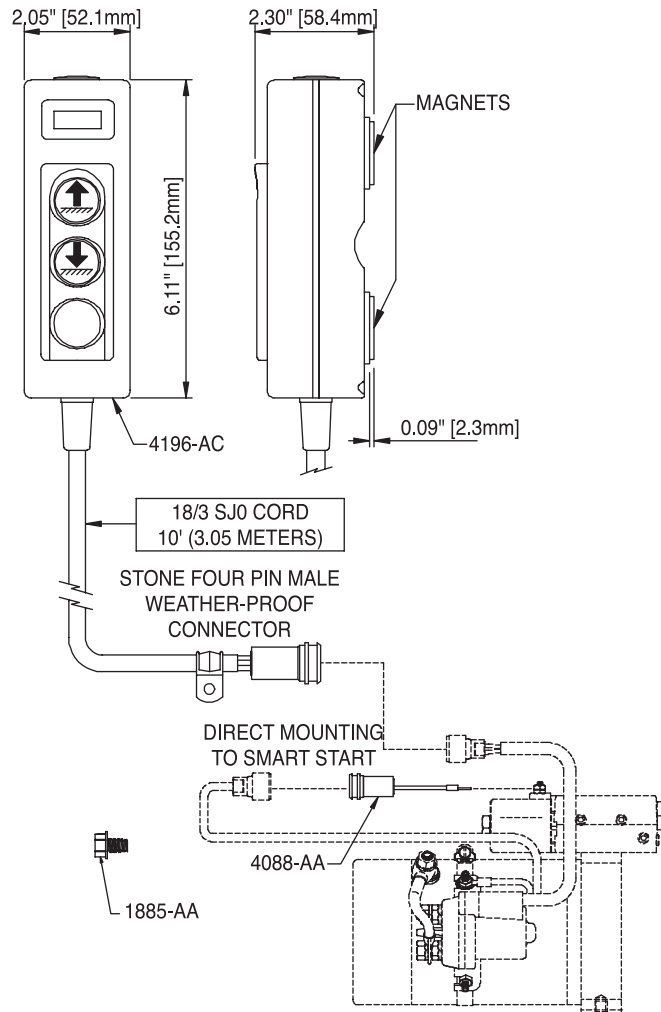

DC voltage only.

To be used with DC-70SF and DC-70BS power units, using KS5 start solenoid.

For bulkhead mounting, order holster 2817-AA.

For wall mounting, order bracket hook 2686-AA.

Magnets are intended for convenience during use. They are not intended to support the handset during motion.

Use 3467-AA jumper when using 24 volts.

Order 3553-AA when wiring smart start to other than Stone supplied cordset.

KG13

CONTROL HANDSET FOR DOUBLE-ACTING UNITS

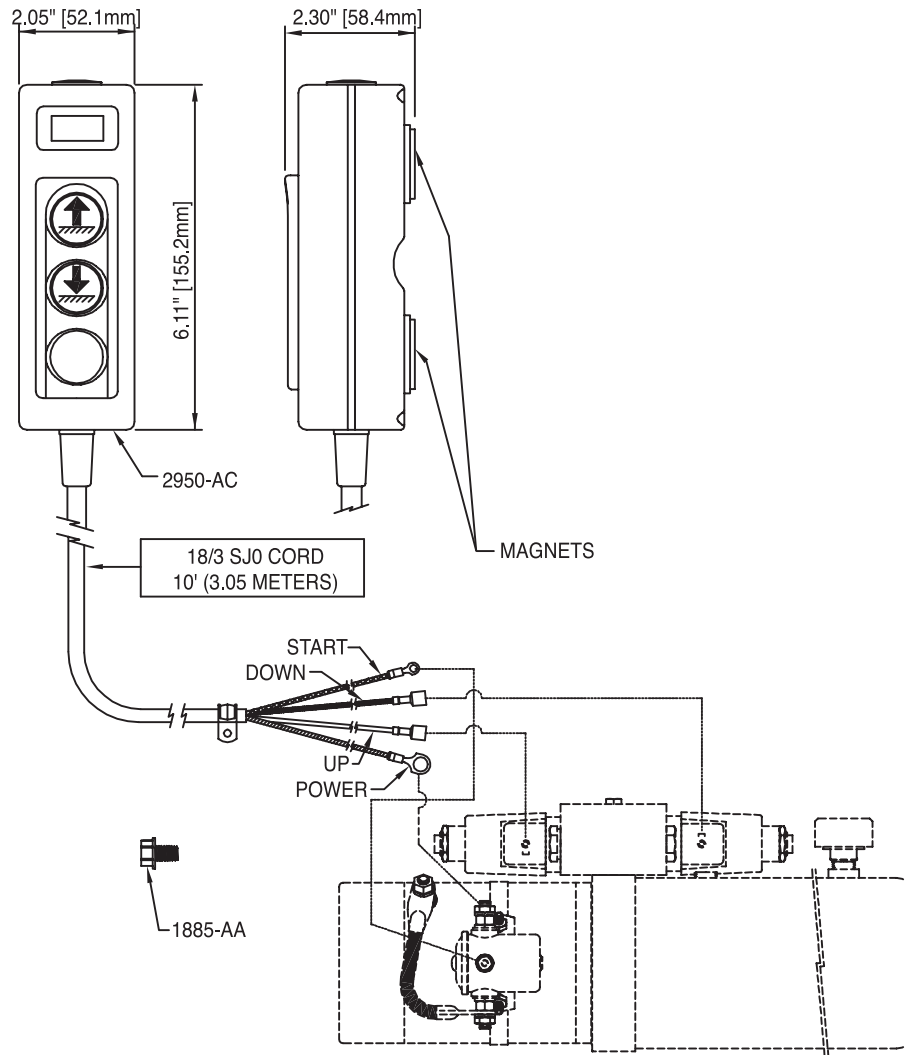

DC voltage only.

To be used with DC-60SF power unit and KS_ start solenoid.

For bulkhead mounting, order holster 2817-AA.

For wall mounting, order bracket hook 2686-AA.

Magnets are intended for convenience during use. They are not intended to support the handset during motion.

WIRE COLOR CODE		
EUROPE	UNITED STATES	FUNCTION
BROWN	GREEN	POWER
BLUE	WHITE	UP
GREEN/YELLOW	BLACK	DOWN
BLACK	RED	START

CONTROL HANDSET FOR DOUBLE-ACTING UNITS FOR SMART START

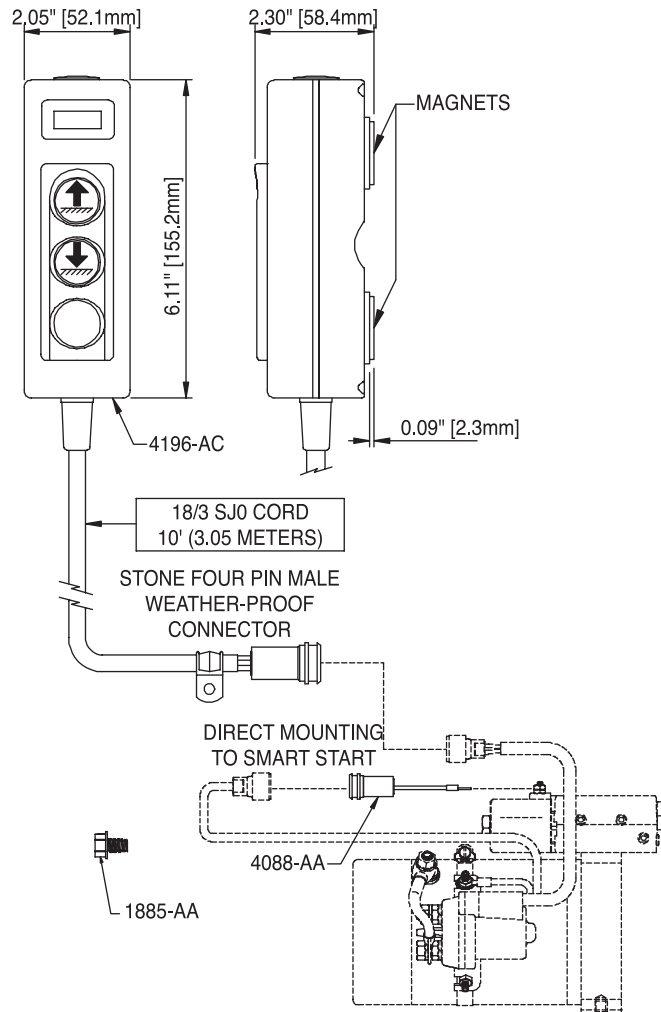

DC voltage only.

To be used with power units using KS5 start solenoid.

For bulkhead mounting, order holster 2817-AA.

For wall mounting, order bracket hook 2686-AA.

Magnets are intended for convenience during use. They are not intended to support the handset during motion.

Use 3467-AA jumper when using 24 volts.

Order 3553-AA when wiring smart start to other than Stone supplied cordset.

TA-01-B

PRESSURE ALARM

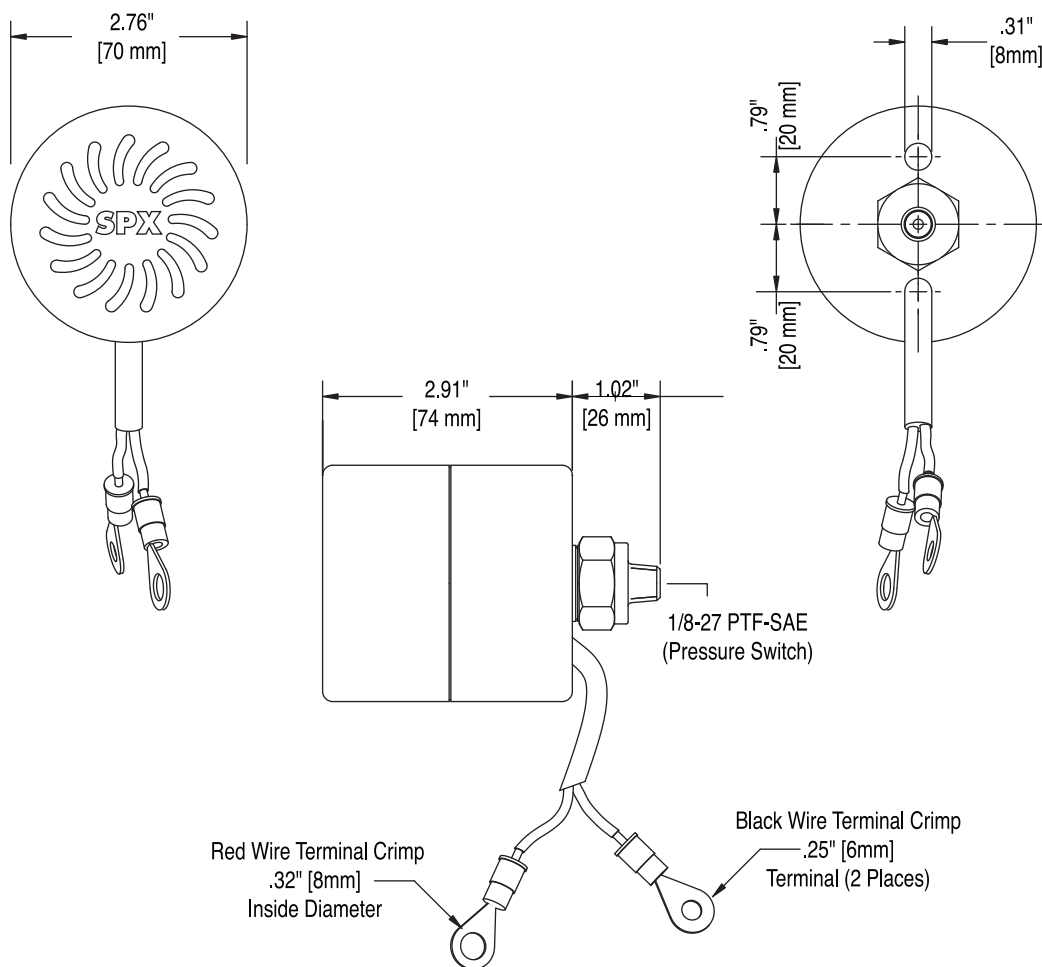

RED WIRE IS POSITIVE (+) BLACK WIRE IS NEGATIVE (-)

MODEL NO.	DESCRIPTION	LEAD LENGTH	AUDIBLE ALARM
TA-01-B	END HEAD MOUNT	304mm	BUZZER

Sounds when pressure is present, indicates that the lift is activated, operates at 12 and 24V DC, 2.5 W, alarm noise level 100 DB, 980 Hz, normally open switch closes at 2 to 4 bar, max pressure 344 bar, pressure washable.