

**145 TC configuration**

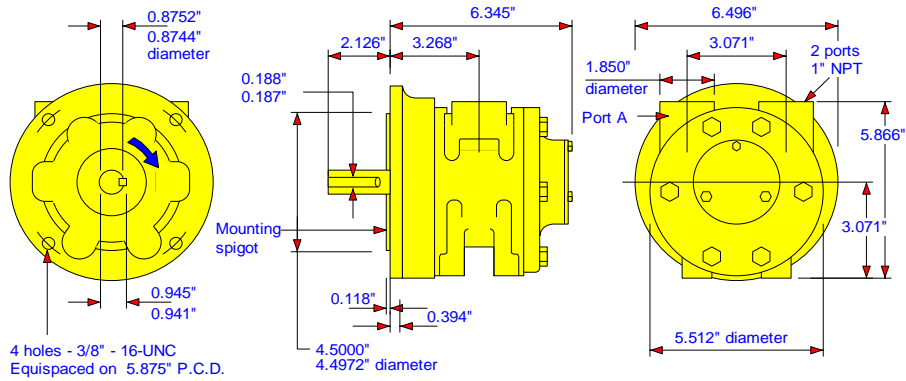

Attitude: The motor can be operated in all positions  
 Maximum temperature -20°C to +80°C (-4°F to +176°F)  
 Muffler supplied with motor

Max. Overhung Force on shaft 620 N (140 lbf.)  
 Axial loads should be kept to a minimum  
 Mass 11.80 kg (26.01 lb.)

**Note: With air inlet at port 'A', shaft rotation is clockwise looking on shaft.  
 For opposite rotation reverse ports.  
 Motor is reversible**

**Foot mounting configuration**

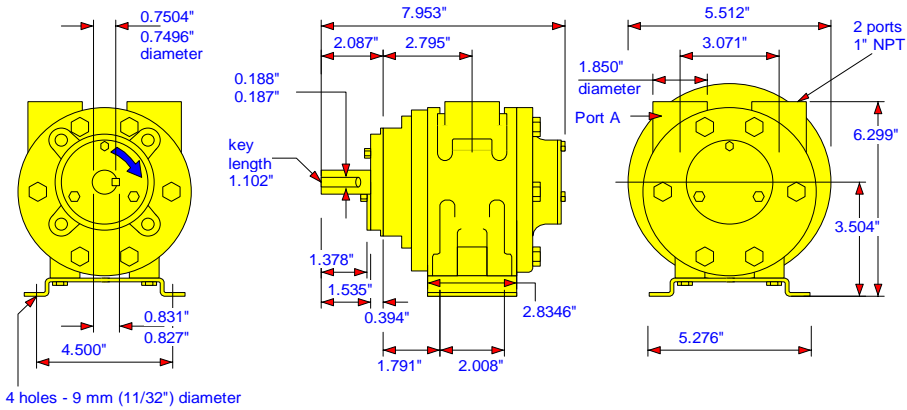

Attitude: The motor can be operated in all positions  
 Maximum temperature -20°C to +80°C (-4°F to +176°F)  
 Muffler supplied with motor

Max. Overhung Force on shaft 620 N (140 lbf.)  
 Axial loads should be kept to a minimum  
 Mass 11.10 kg (24.46 lb.)

**Note: With air inlet at port 'A', shaft rotation is clockwise looking on shaft. For opposite rotation reverse ports. Motor is reversible**

Face mounting configuration

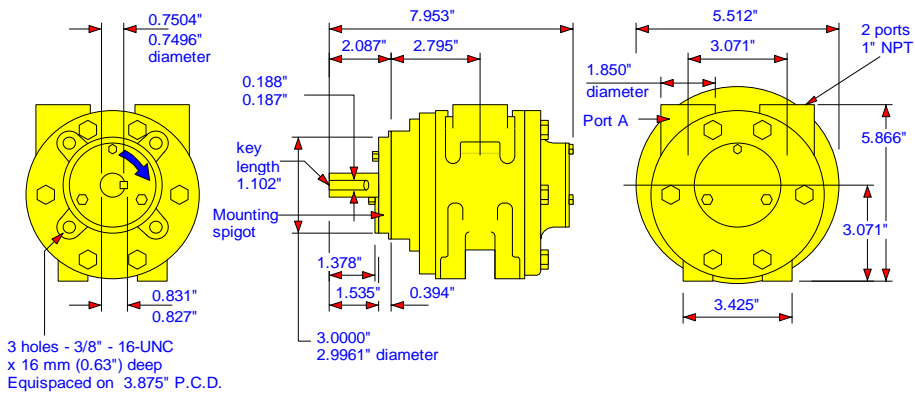

Attitude: The motor can be operated in all positions  
Maximum temperature -20°C to +80°C (-4°F to +176°F)  
Muffler supplied with motor

Max. Overhung Force on shaft 620 N (140 lbf.)  
Axial loads should be kept to a minimum  
Mass 11.10 kg (24.46 lb.)

**Note: With air inlet at port 'A', shaft rotation is clockwise looking on shaft.  
For opposite rotation reverse ports.  
Motor is reversible**

**D90 configuration**

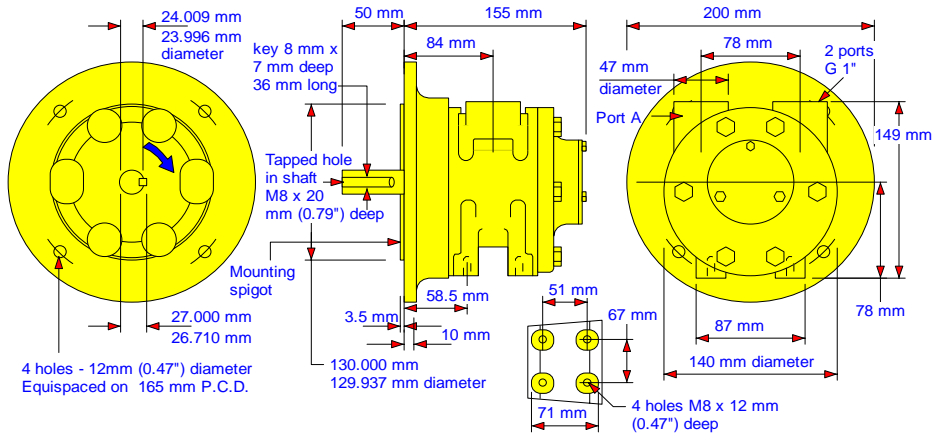

Attitude: The motor can be operated in all positions  
 Maximum temperature -20°C to +80°C (-4°F to +176°F)  
 Muffler supplied with motor

Max. Overhung Force on shaft 620 N (140 lbf.)  
 Axial loads should be kept to a minimum  
 Mass 12.20 kg (26.89 lb.)

**Note: With air inlet at port 'A', shaft rotation is clockwise looking on shaft. For opposite rotation reverse ports. Motor is reversible**

**Maximum continuous speed 3000 rpm**

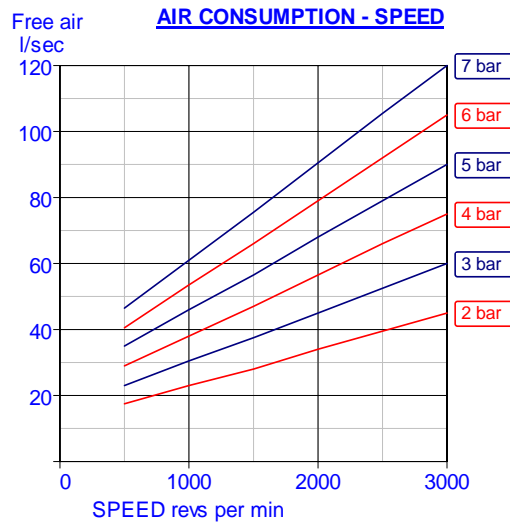
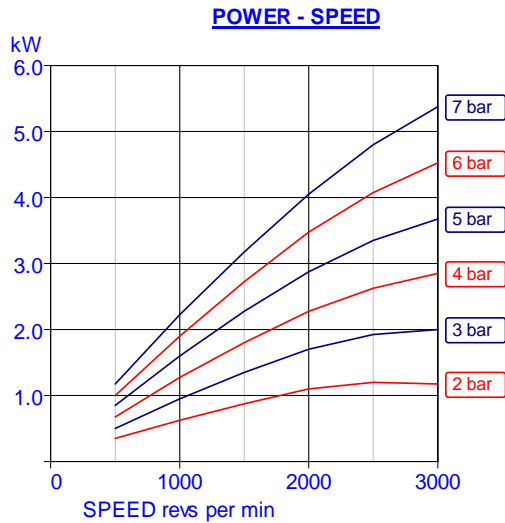
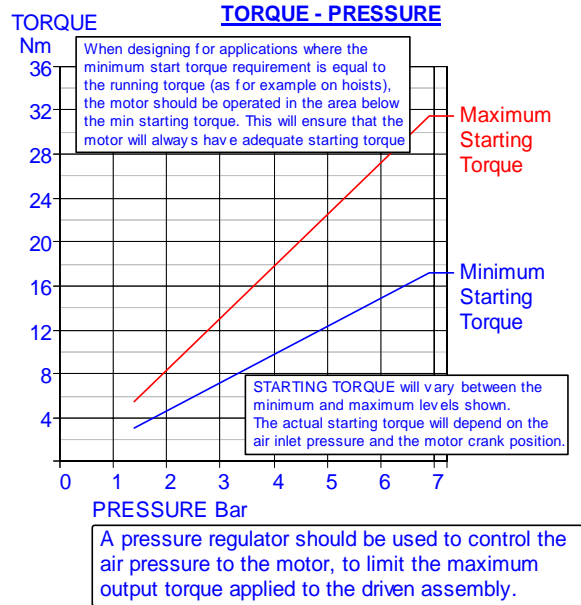
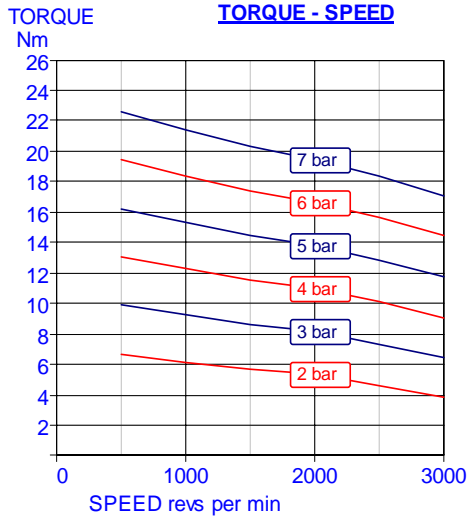

Muffler supplied with motor  
Motor is reversible

Attitude: The motor can be operated in all positions  
Maximum temperature -20°C to +80°C (-4°F to +176°F)

Max. Overhung Force on motor shaft 620 N (140 lbf.)  
Axial loads should be kept to a minimum

**AIRLINE FILTRATION AND LUBRICATION**

Use 64 micron filtration or better. Choose a lubricator suitable for the flow required. Prior to initial start-up, inject oil into the inlet port.  
Lubricator drop rate 6-7 drops/minute continuous operation  
Lubricator drop rate 12-15 drops/minute intermittent operation

# VA8C Motor Spare Parts List

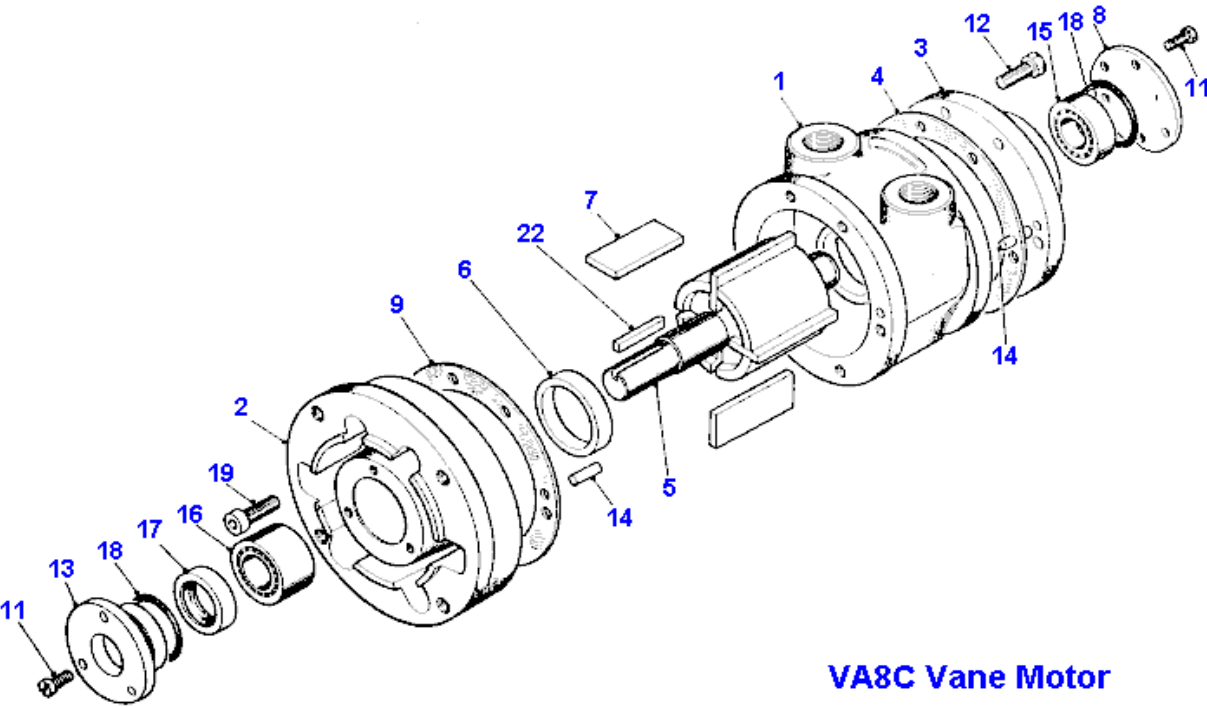

## VA8C Vane Motor

If unit is pre 1990 supply consult manufacturer to confirm design

Item	Part No.	Description	Qty	Kit No.
01	780-001	Body NPT	1	
02	780-018	Front Plate NEMA 145 TC	1	
03	780-002	End Plate	1	
04	-	Gasket	2	789-910
05	780-910	Rotor Shaft Assy	1	
06	780-006	Ejection Ring	2	
07	-	Blades	4	789-910
08	740-008	Cover Plate	1	
09-1	-	Gasket	1	789-910
09-2	-	Gasket	1	789-910
09-3	-	Gasket	1	789-910
11	802-001	Screw	6	
12	802-032	Screw	6	
13	780-007	Seal Housing	1	
14	806-024	Dowel	4	
15	807-026	Bearing	1	
16	807-036	Bearing	1	
17	-	Oil Seal	1	789-910
18	-	O Ring	2	789-910
19	809-030	Screw	6	
22	811-020	Key	1	
	789-910	V8 Seal Kit		
	820-026	Silencer 1" NPT	1	

# VA8J / VA8X Motor Spare Parts List

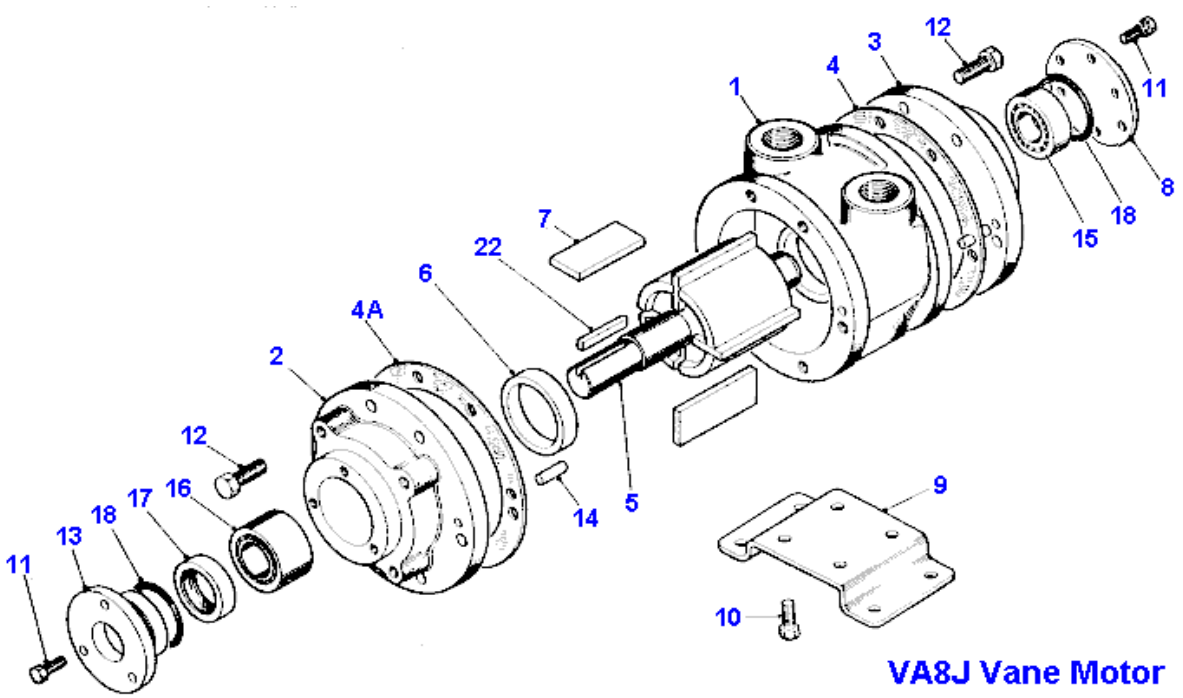

**VA8J Vane Motor**

If unit is pre 1990 supply consult manufacturer to confirm design

Item	Part No.	Description	Qty	Kit No.
01	780-001	Body NPT	1	
02	780-003	Front Plate	1	
03	780-002	End Plate	1	
04	-	Gasket	2	789-910
04A-1	-	Gasket	1	789-910
04A-2	-	Gasket	1	789-910
04A-3	-	Gasket	1	789-910
05	780-911	Rotor Shaft Assy	1	
06	780-006	Ejection Ring	2	
07	-	Blades	4	789-910
08	740-008	Cover Plate	1	
09	780-023	Foot	1	
10	809-026	Capscrew	4	
11	802-001	Screw	6	
12	802-032	Set Screw	12	
13	780-007	Seal Housing	1	
14	806-024	Dowel	4	
15	807-026	Bearing	1	
16	807-036	Bearing	1	
17	-	Oil Seal	1	789-910
18	-	O Ring	2	789-910
22	811-021	Key	1	
	789-910	V8 Seal Kit		
	820-026	Silencer 1" NPT	1	

# VS8C Motor Spare Parts List

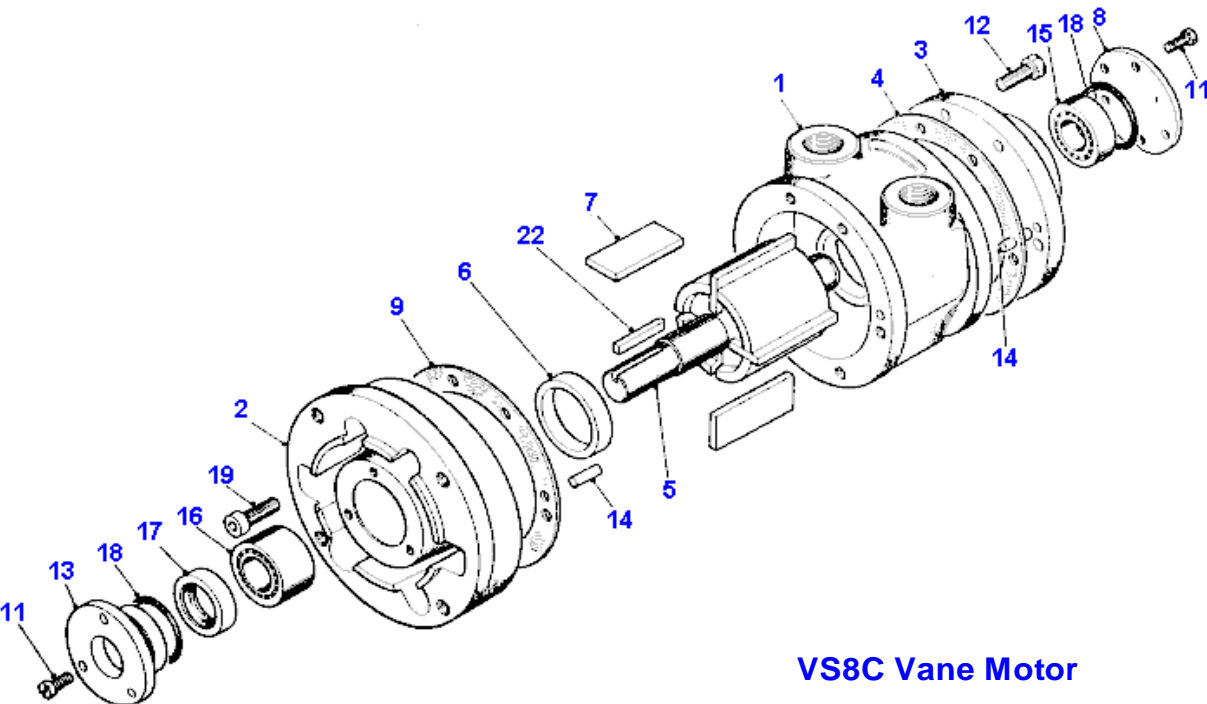

**VS8C Vane Motor**

If unit is pre 1990 supply consult manufacturer to confirm design

Item	Part No.	Description	Qty	Kit No.
01	780-101	Body BSP	1	
02	780-036	Front Plate D90	1	
03	780-002	End Plate	1	
04	-	Gasket	2	789-910
05	780-922	Rotor Shaft Assy	1	
06	780-006	Ejection Ring	2	
07	-	Blades	4	789-910
08	740-008	Cover Plate	1	
09-1	-	Gasket	1	789-910
09-2	-	Gasket	1	789-910
09-3	-	Gasket	1	789-910
11	802-001	Screw	6	
12	802-032	Screw	6	
13	780-007	Seal Housing	1	
14	806-024	Dowel	4	
15	807-026	Bearing	1	
16	807-036	Bearing	1	
17	-	Oil Seal	1	789-910
18	-	O Ring	2	789-910
19	809-030	Screw	6	
22	811-042	Key	1	
	789-910	V8 Seal Kit		
	820-006	Silencer 1" BSP	1	